

# PROPOSED DESIGN AND PLANNING WORKS FOR MILAN MELA PHASE II

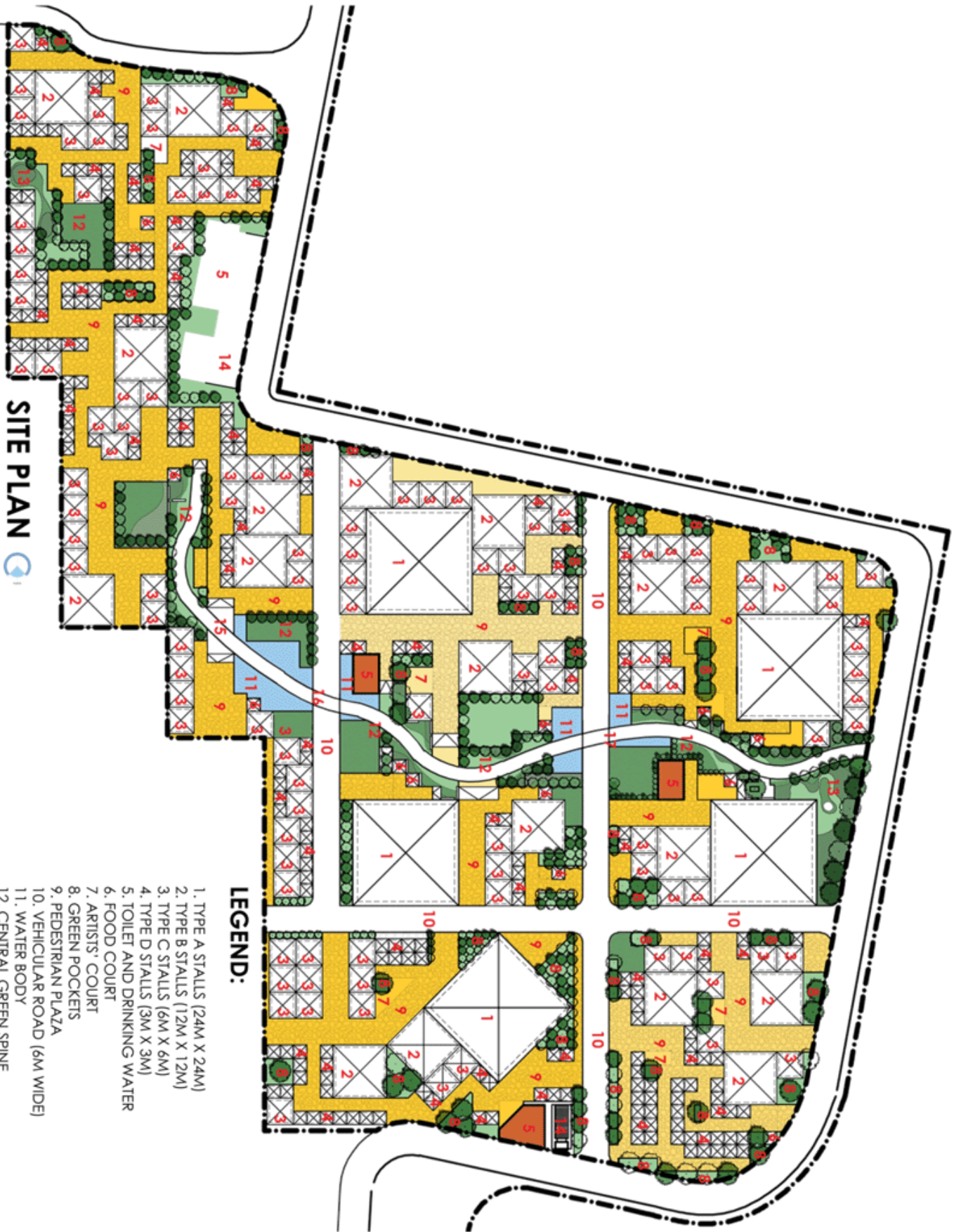

**SITE PLAN**

## LEGEND:

1. TYPE A STALLS (24M X 24M)
2. TYPE B STALLS (12M X 12M)
3. TYPE C STALLS (6M X 6M)
4. TYPE D STALLS (3M X 3M)
5. TOILET AND DRINKING WATER
6. FOOD COURT
7. ARTISTS' COURT
8. GREEN POCKETS
9. PEDESTRIAN PLAZA
10. VEHICULAR ROAD (6M WIDE)
11. WATER BODY
12. CENTRAL GREEN SPINE
13. CHILDREN'S PLAY AREA
14. PARKING FOR FIRE TENDER
15. HOWRAH BRIDGE REPLICA
16. VIDYASAGAR SETU REPLICA
17. VIVEKANANDA SETU REPLICA